

# STAINLESS STEEL TENSION CATCH



# BCTS

CATCHES & LATCHES

STAINLESS STEEL TENSION CATCHES / ZINC TENSION CATCHES

- 316 stainless steel catch for high corrosion resistance.
- Tension force is not adjustable.

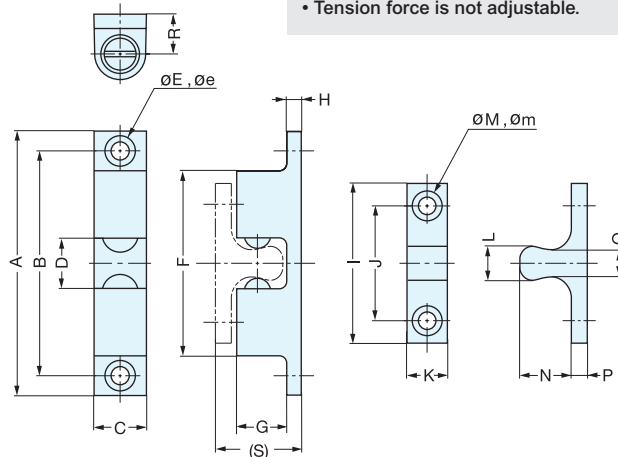
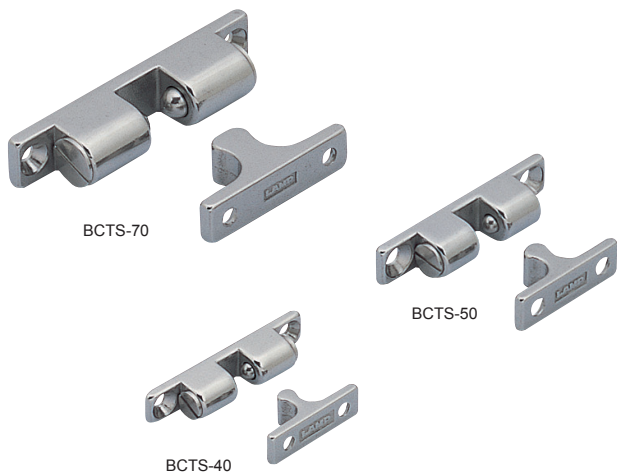

Item No.	A	B	C	D	E	e	F	G	H	I	J	K	L	M	m	N	P	Q	R	(S)
BCTS-40	43 (1-11/16")	35	8	5.9	3.2	6.2	28.4	7.5	2.5	25 ( 63/64")	16	7.5	4.5	3.2	6.2	8.5	2.5	2.7	6.0	13.5
BCTS-50	50 (1-31/32")	40	10	7.5	4.2	8.2	31.5	9.3	2.9	30 ( 1-3/16")	20	9.0	6.0	4.2	8.2	10.3	2.9	3.8	7.2	16.1
BCTS-70	70 ( 2-3/4")	60	13	13.0			51.0	13.0	4.0	42 (1-42/64")	30	10.5	10.0		8.2	15.0	4.0	8.0	10.5	23.0

Item No.	Push in Force (kg)	Pulling Force (kg)	Weight (g)	Box (pcs)	Carton (pcs)	Part name	Material	Finish
BCTS-40	2.0 ( 4.4 lbs )	1.3 ( 2.9 lbs )	18	50	500	Body	316 Stainless Steel	Polished
BCTS-50	2.3 ( 5.0 lbs )	1.8 ( 3.9 lbs )	30			Strike		
BCTS-70	5.7 ( 12.5 lbs )	3.9 ( 8.5 lbs )	83	25	250	Spring	304 Stainless steel	

# TENSION CATCH



# BCT

- Tension force is not adjustable.

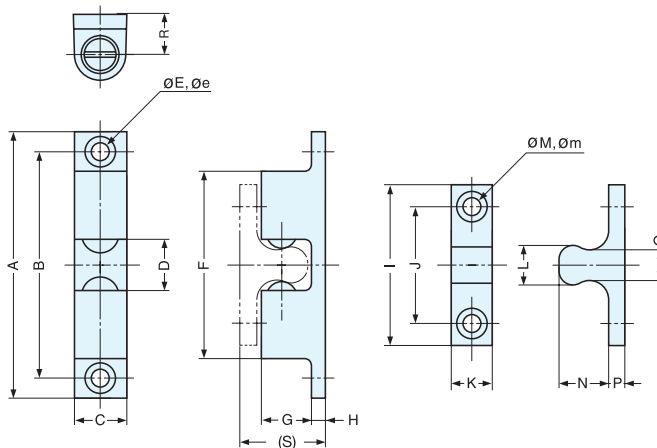
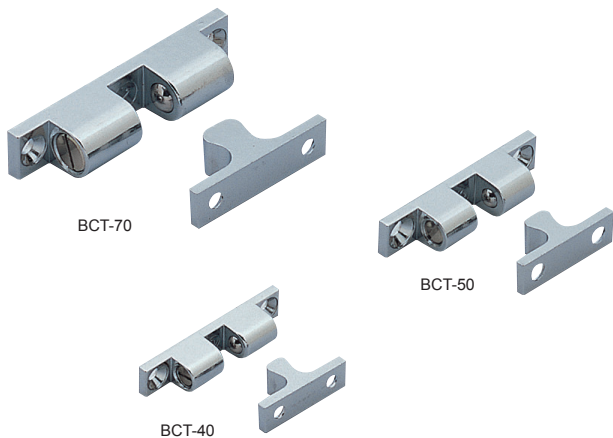

Item No.	A	B	C	D	E	e	F	G	H	I	J	K	L	M	m	N	P	Q	R	(S)
BCT-40	42.5 (1-43/64")	35	8.0	6.3	3.2	6.2	26.7	7.5	2.5	25 ( 63/64")	16	7.5	5.5	3.2	6.2	8.8	2.5	3.7	6.25	13.8 ( 35/64")
BCT-50	50.0 (1-31/32")	40	10.0	8.4	4.2	8.2	29.8	9.5	3.0	30 ( 1-3/16")	20	9.0	7.3	4.2	8.2	9.8		4.7	7.75	15.3 ( 19/32")
BCT-70	70.0 ( 2-3/4")	60	13.5	13.0			49.0	13.0	4.0	42 (1-42/64")	30	10.5	11.0		8.2	14.2	3.0	8.2	10.50	21.2 ( 27/32")

Item No.	Push in Force (kg)	Pulling Force (kg)	Weight (g)	Box (pcs)	Carton (pcs)	Part name	Material	Finish
BCT-40	4.4 ( 9.7 lbs )	3.0 ( 6.6 lbs )	16	100	400	Body & Strike	Zinc Alloy	Chrome
BCT-50	4.1 ( 9.0 lbs )	3.3 ( 7.3 lbs )	26			Spring	Steel	Plain
BCT-70	4.6 ( 10.1 lbs )	3.5 ( 7.7 lbs )	70	50	200	Cover	Brass	Nickel
						Ball	Steel	Polished